

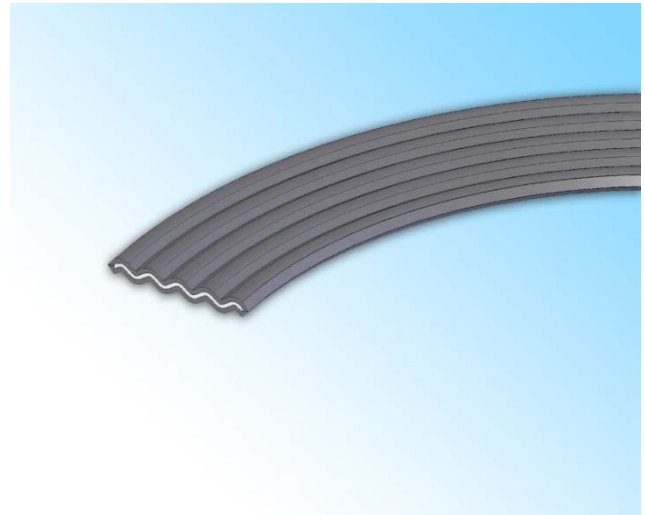

MAXIGRAPH



Klinger Maxigraph consists of a corrugated metallic core encapsulated by a graphite coating. Excellent microsealing performance from the graphite is combined with the strength of the metallic core.

- » Corrugations in the core develop high stress areas to produce a gasket with excellent leak-tightness at low bolt loads.
- » Corrugations prevent extrusion of the facing material
- » Uniform graphite density across the profile ensures excellent adaptability of the facing at the peaks to create a good seal even on worn flanges
- » Excellent chemical resistance
- » Gasket core is totally encapsulated by the facing layer improving resistance to the process media
- » Good gasket rigidity, even for narrow sealing widths
- » Robust and easy to handle

APPLICATIONS:

- » Vessel applications with narrow seating widths
- » Pipeline applications
- » Suitable for a wide range of application temperatures and can be used in cryogenic applications

TYPICAL PROPERTIES:

- » Corrugated metallic core provides the gasket with improved handling characteristics over graphite laminates
- » Corrugations on the core create high stress regions to allow excellent sealing properties even with low gasket loads
- » Provides greater recovery properties than graphite laminate gaskets

TYPICAL SPECIFICATIONS:

- | | |
|--------------------|------------------|
| » Material | 316L/Graphite |
| » Max. Temperature | 450°C |
| » Max. Pressure | 100 Bar |
| » Thickness | 2.5mm (standard) |

* Other core materials available

** Can be manufactured with PTFE facing; Klinger Maxiflon

HEAD OFFICE

KLINGER Ltd
Wharfedale Road
Euroway Trading Estate
Bradford BD4 6SG

Tel: 01274 688 222
Fax: 01274 688 549
www.klinger.co.uk
enquiries@klingeruk.co.uk

KLINGER RUNCORN

Tel: 01928 577 030
Fax: 01928 575 233

KLINGER SOUTHAMPTON

Tel: 02380 611 855
Fax: 02380 610 360

KLINGER ABERDEEN

Tel: 01224 772 962
Fax: 01224 772 953

KLINGER IMMINGHAM

Tel: 01469 575 289
Fax: 08449 676 779

KLINGER MIDDLESBROUGH

Tel: 01642 220 289
Fax: 01642 220 290

KLINGER GRANGEMOUTH

Tel: 01324 472 231
Fax: 01324 482 111



FM 602916

FM 10571

OHS 570166

EMS 570165